

**REFRIGERATOR MANUFACTURER**  
**Turbo air**  
 more durable, efficient, beautiful

4184 E. Conant St.  
 Long Beach, CA 90808  
 Tel. 310-900-1000  
 Fax. 310-900-1077  
[www.turboairinc.com](http://www.turboairinc.com)

Project :  
 Model # :  
 Item # : Qty :  
 Available W/H :  
 Approval :

## Swing Door Freezers

Glass Door Merchandisers  
 Super Deluxe Series

**Model : TGF-35SD**

### FEATURES & BENEFITS

- **High-tech monitor self-diagnosis system**  
 The unit will beep if the door has been opened for more than 30 seconds. The monitor digitally displays the present temperature and current status of the freezer. You can easily change the temperature by adjusting the thermostat. When a refrigerator breaks, it will immediately run a self-diagnosis to figure out what the problem is, saving both service time and unnecessary expenses that could have occurred by misdiagnosis.
- **Smart defrost system**  
 Generally, a freezer's defrost timer defrosts automatically for a fixed length of time regardless of the existing conditions of the freezer. Turbo Air's "Smart Defrost System" analyzes its surrounding environments and defrosts only when it is needed for the required time. This not only saves energy but also keeps the contents of the freezer safe.
- **No electrical frame heater is needed**  
 Turbo Air is the first in the industry to replace a frame heater with a method of using compressor-produced heat. This eliminates any unnecessary energy consumption while providing efficient freezing performance.
- **Energy conserving fan control**  
 Utilizing algorithmic air circulation for optimal temperature levels, our innovative fan control system conserves energy by at least 15% and increases compressor life by up to 30%.
- **Turbo Freeze feature for faster freezing**  
 When in Turbo Freeze mode, the built-in program allows the compressor to run continuously for two hours. This helps the temperature to decrease more quickly inside the cabinet, which results in reaching freezing temperatures much faster.
- **LED lighting interior display**  
 Brighter and longer lasting LED lights provide attractive, enhanced illumination compared to fluorescents. It saves energy by producing less heat, while maximizing the visibility in the display area.
- **Door opening alarm & early warning device**  
 If the doors are not tightly closed, the freezer will not run. This would cause the cold air to escape through the opening, making food products spoil inside the cabinet. To prevent this problem, our freezers are equipped with the Door Alarm System that will sound if the doors are left open for more than 30 seconds. Turbo Air units have a warning system in place that diagnoses and monitors itself for risk factors, which gives an early warning signal in the form of an audible alarm to eliminate product loss and future service issues.
- **Triple pane heated glass doors**  
 Equipped with unique triple-pane heated glass doors which enhance energy efficiency by preventing heat transfers and minimizing condensation. Lightweight door construction reduces door maintenance, bushing wear, and facilitates smooth door opening.
- **Shadow free advertising panel**  
 Turbo Air is the pioneer in the refrigerator industry on applying special LED Light Guided Panels (LGP). LED lighting offers 10 times longer lasting life than fluorescents and conserves energy as well
- **Efficient refrigeration system**  
 Turbo Air's freezers are designed with oversized and balanced (CFC Free R-404A) refrigeration systems. These include efficient evaporators and condensers for faster freezing and greater efficiency.

**3 YEAR PARTS & LABOR WARRANTY**



TGF-35SDW



TGF-35SDV



TGF-35SDB

**Freezer holds -15°F ~ 5°F for the best in frozen food preservation**

ENERGY STAR®  
 Qualified



Model	Swing Door	CU./FT.	#of Shelves	HP	AMPS	Crated Weight (lbs.)	L x D* x H† (inches)
TGF-35SD	2	37.0	8	1 1/4	11.5	519	39 1/2 x 31 7/8 x 77

# Swing Door Freezers

Glass Door Merchandisers  
Super Deluxe Series

## Model : TGF-35SD

ELECTRICAL DATA	
Voltage	115/60/1
Plug Type	Ⓢ NEMA 5-20P
Full Load Amperes / LRA	11.5 / 98
Compressor HP	1 1/4
Cord Length ft.	7
Refrigerant	R-404A
DIMENSIONAL DATA	
# of Doors	2
Net Capacity cu. ft.	37.0
Ext. Length Overall in.	39 1/2 (1004mm)
Ext. Depth Overall in.*	31 7/8 (809mm)
Ext. Height Overall in.†	77 (1956mm)
Int. Length Overall in.	35 5/8 (904mm)
Int. Depth Overall in.	27 1/2 (699mm)
Int. Height Overall in.	60 3/8 (1535mm)
Net Weight lbs.	454
Gross Weight lbs.	519
# of Shelves	8
Shelf Size (LxD) in.	18 x 23 3/8

Design and specifications subject to change without notice.  
Actual shipping weight may differ due to extra packing materials for product protection.  
\* Depth does not include 2-1/4" (57mm) for door handle.  
† Height does not include 2-1/2" (63mm) for leg height.

■ **WARRANTY : 3 Year Parts and Labor Warranty  
Additional 2 Year Warranty on Compressor**

- **Door locking system standard**
- **Price tag channel shelf available (optional)**
- **Optional 4" casters available - 1/2" diameter & 13 TPI**
- **Three color options available (standard) :**  
Super Deluxe series comes in white cabinet (W),  
white cabinet with wine color trim (V) or  
black cabinet with black color trim (B).

## PLAN VIEW

(unit : inch)

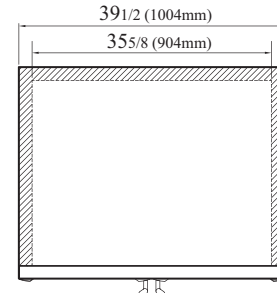

TOP VIEW

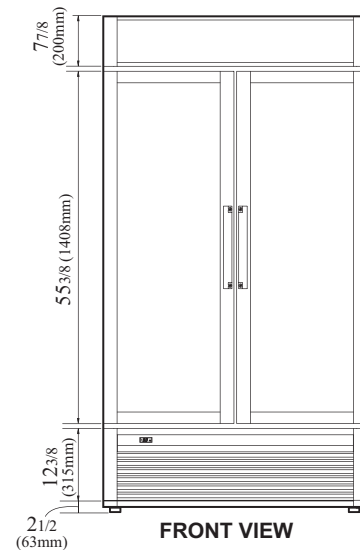

FRONT VIEW

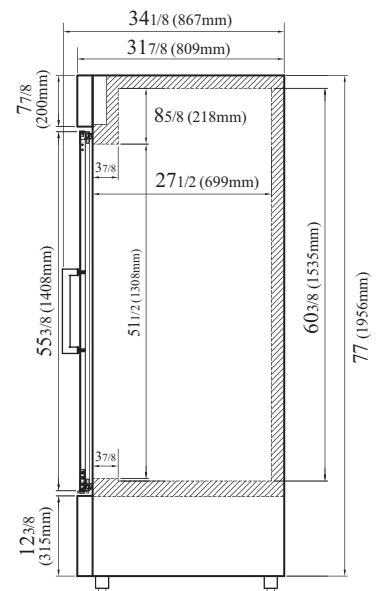

SIDE VIEW

Ver.201501



- Turbo Air : 800-627-0032
- GK : 800-500-3519
- Warranty : 800-381-7770
- AC : 888-900-1002

